

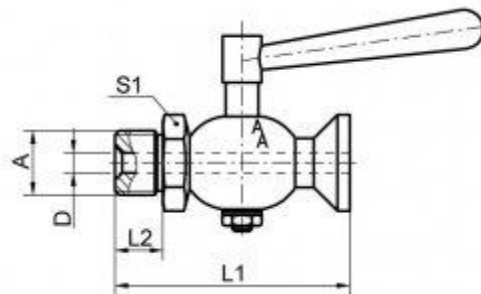

Robinex AG
Alte Distelbergstrasse 1
5035 Unterentfelden

Tel. 062 787 70 00
Fax. 062 787 70 01
info@robinex.ch / verkauf@robinex.ch

Ablasshahn, FIG.180



Ablasshahn

Ausführung, Aussengewinde x gerader Auslauf

Material: Edelstahl 1.4571

A	PN / bar	C	D / mm	L1 / mm	L2 / mm	S1 / mm
G 1/8"	6	50	4	39	9	19
G 1/4"	6	50	4	39	10	19
G 3/8"	6	50	6	44	10	22
G 1/2"	6	50	8	55	14	27
G 3/4"	6	50	12	66	16	32
G 1"	6	50	15	84	20	41
G 1 1/4"	6	50	18	110	22	50